



EMELŐ
WEBSHOP

rockexotica®
GEAR FOR THE Z AXIS

FROM ROCK

Rock Exotica began in a garage in 1987. Much has changed since those days of manual production and graph paper designs. However, one thing has stayed the same: Our desire to produce the most innovative technical equipment available. It is our passion to make the best gear in the world and I hope you agree that every piece of gear exhibits this philosophy and sets us apart. In an age when many companies no longer actually make anything, but rather just promote their brand and sub out the manufacturing, we are an anachronism. We manufacture our gear ourselves, in Utah. We've never gone in search of foreign low-cost products upon which to only place our brand, and we never will.

It has been a great journey and there is much more to come. We've had a lot of help from the real experts in the field. Thanks to you all for helping Rock Exotica to become the leader in innovative technical equipment and for allowing me to have the best job in the world.

Rock Thompson

Rock Thompson
Climber, Designer, President

www.emelowebshop.hu



M A D E N U S A

MACHINED FROM SOLID | METHOD

Many methods exist to produce technical pieces of hardware. From the beginning of Rock Exotica, machining parts from solid blocks of aluminum and steel was the best way to achieve the desired strength, fit, and precision needed for the ultimate function of many of our products.

This method that we felt was crucial to our products back in 1987 is still important to our most popular pieces of equipment today. Revolutionary tools like the Omni Swivel Pulley, AZTEK Pulley System, and the rockStar 3D Rigplate (shown below) just to name a few, are all products whose key characteristics are made possible by the CNC machining expertise we've developed over two decades. In the crowded field of carabiners, where one might make the mistake of thinking that all are created equal, Rock Exotica carabiners offer impressive and unique characteristics in part because the frames are machined and not forged. The same is true for our pulleys and other products.

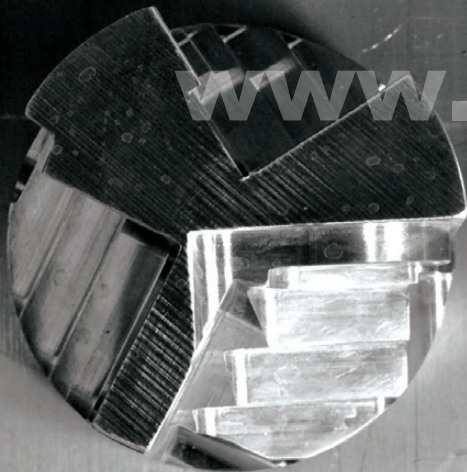

www.emelowebshop.hu

The pages that follow will show various pieces of hardware that have important differences and characteristics that set them apart from other equipment in the field. The factors that achieve such status are a combination of many things, but you can be assured that a majority of Rock Exotica products admired by professionals share the unique trait of being born from a solid piece of material.

O U R M E T H O D S

CARABINER | INTRODUCTION

Many carabiners are alike, with no significant differentiation from one to another, be that lack of difference in function or materials. For Rock Exotica, if we couldn't make a carabiner that had significant advantages to the average carabiner, we wouldn't manufacture any! Since the beginning, we have tried to produce carabiners with important design elements that make our carabiners unique. We find inspiration for these improvements from the professionals who depend on them for their livelihood as well as their lives. Each one of our carabiners has unique characteristics depending on the gate and sleeve combinations. The advantages and specific attributes of each are shown on the pages that follow.

MACHINED FRAME

Once the rod of aluminum is bent to the shape of the carabiner, the carabiner "frame" is CNC machined along the areas where the gate and sleeve connect. As a result, we can build a precise attachment and operating surface for the carabiner mechanism. This machining process produces a part to exact specifications in a way that stamping and forging are unable to achieve. This exact fit, by way of machining, provides for a smooth action as well as the means to have an angled gate.



ANGLED GATE

The large gate clearance or opening of Rock Exotica carabiners is made possible in part by the angled surfaces machined into the carabiner frame. This angle pushes the gate off to the side as it reaches the rear of the carabiner, causing the gate to travel past the spine. The angle of the gate opening also fits the natural travel of the hand as it pulls the gate backwards.

ORCA

The ORCA is a patented 3-stage gate and sleeve combination available on all three of our aluminum carabiner shapes. It represents a significant advance in carabiner technology since it can be set to open quickly like a non-locker, but closes with the security of an autolock.

AUTOLOCK

The Rock Exotica 3-stage autolock uses a unique pull-down gate that's more intuitive to operate than the traditional push-up gate. The autolock features beveled surfaces on the inside contact areas of the carabiner to reduce the risk of ropes, lanyards or equipment getting hung up and cross-loaded.

www.emelowebslp.hu



The machined frame ensures a precise fit with the gate and sleeve, as well as the other components used in the carabiner. Also machined into the frame is the angle for the wide gate clearance.

SHAPES

ALUMINUM CARABINER

Rock Exotica offers 3 aluminum carabiner shapes. Pirate, rockD and rockO. All three shapes have slightly angled gate openings that allows them to open farther, as well as a snag free key-lock nose design.



PIRATE (HMS)

The Pirate is our HMS or pear shaped carabiner, it is the most versatile shape allowing a wider variety of gear, webbing and rope to fit effortlessly. The Pirate is a favorite among Rock Exotica users due to its perfect balance of strength and utility.

rockD (ASYMETRIC D)

The rockD is the strongest of the Rock Exotica shapes, keeping the loads close to the spine where the strength is. The rockD is a staple among work and rescue professionals.

rockO (OVAL)

The rockO is a blend of the traditional oval and the rockD giving it more strength than the standard oval. This design is great for users that need extra room at the bottom of the carabiner while keeping their gear aligned.

Get quick access to your locking carabiner without the gymnastics required to open the traditional three-stage autolocker.

ORCA | GATE

The ORCA is an enhanced 3-stage mechanism available on Pirate, rockD and rockO carabiners. This unique gate system lifts up and twists just like many traditional autolocks, but can be set to remain in the unlocked position. This allows the gate—whether you attach the ORCA carabiner immediately, or leave it installed in an anchor to connect a line later, to open easily, just like a non-locker. And when it closes, it closes and rotates shut with the safety and surety of a locking carabiner.

READY

www.emelowebshop.hu

MECHANISM:
**ENHANCED
THREE STAGE**



Up
1



Twist
2



Ready



Open
3

Available on:

- C1 O (Pirate ORCA)
- C2 O (RockD ORCA)
- C3 O (RockO ORCA)



GATE | AUTOLOCK

The Rock Exotica 3-stage Autolock stands out from the crowd with an ergonomic pull-down sleeve, smooth edges on the interior of the carabiner, and a convenient lock status indicator.



MECHANISM:
THREE STAGE



Down

1



Twist

2



Open

3

PULL-DOWN SLEEVE

The 3-stage Autolocking carabiner features a pull-down and twist action — a motion that's more intuitive and natural for your hand than lifting up and away from your palm. Once you try it, you're likely to never go back!



SMOOTH EDGES

No detail is ever overlooked in the design and manufacture of our equipment. We identified several surfaces where ropes and lanyards can be held up by the edges of the gate and sleeve, which can lead to dangerous cross-loading. We have designed our autolock sleeve with beveled edges to minimize this risk, and provide a smoother interior for the materials connected to the carabiner.



Available on:

- C1 A (Pirate Autolock)
- C2 A (RockD Autolock)
- C3 A (RockO Autolock)



Our Screwlock carabiner features all anodized parts to increase longevity, and a gate design that prevents the sleeve from ever detaching from the gate.

SCREWLOCK | GATE



Unscrew

1



Open

2

MECHANISM:
SCREWLOCK



NO ORDINARY SCREWLOCK

Two important features make the Rock Exotica Screwlock unique from all others. First, all aluminum parts are anodized. This is particularly important for the screw-sleeve and gate, which without this coating is more susceptible to corrosion. This protective surface also gives the sleeve a smoother spin. Second, the gate is designed with an enlarged flange at the top. This prevents the screw-sleeve from ever moving past the end of the gate, whereas with other designs, the sleeve can wear past the last thread of the gate and slip off.



Available on:

- C1 S (Pirate Autolock)
- C2 S (RockD Autolock)
- C3 S (RockO Autolock)



WIREEYE

The WireEye holds gear, lanyards and lines with enough resistance to help prevent gear from moving past the end of the carabiner, but releases easily when lifted up.



PIRATE wireEye

C1 WEA (wireEye Autolock)
C1 WES (wireEye Screwlock)



rockO wireEye

C3 WEA (wireEye Autolock)

M A D E I N U S A

With a removeable, high-quality stainless steel pin, installation is easy and secure.

LANYARD PIN



rockD Lanyard Pin
C2 LPA (Lanyard Autolock)

L A N Y A R D P I N

BI-WIRE

The BiWire is a patented double-gate design that offers more security than a standard wiregate. In addition, it is resistant to natural contaminants that can cause other mechanisms to fail.

ROCKD BIWIRE (C2 BW)

The BiWire was developed originally as a more secure alternative to a non-locking, or standard wiregate carabiner. In some cases, a carabiner can be opened by a loop in the rope, or gate coming in contact with another object. The patented double-gate design helps prevent accidental gate openings. To open the BiWire, the user must simultaneously push the outer gate and inward gate. Screwlock or autolock carabiners can become inoperable due to ice, sand or other debris. The BiWire design does not utilize a mechanism to lock. Therefore it is resistant to natural contaminants and debris. This is advantageous when used in harsh environments by mountaineers or canyoneers.



Open the BiWire by spreading the gates open with your index finger and thumb as shown.



We're reintroducing the standard
2-stage gate, or twistlock carabiner
on the strong rockD frame.

2-STAGE



www.emelowebshop.hu

ROCKD TWISTLOCK (C2 T)

The twistlock (2-stage) carabiner, is a quick-detachable alternative to a screwlock or 3-stage autolocker. Requiring only a twist in the sleeve to open, it makes for an ideal locking carabiner to use in situations where equipment or personnel require rapid deployment or disconnection. In fall protection situations where the carabiner is repeatedly attached and detached, the twistlock can save time and help prevent hand fatigue by shortening the steps to disconnect.

Note that by nature, the twistlock carabiner is more easily opened unintentionally than a 3-stage Autolock or Screwlock. Proper training and adherence to safety standards for your industry is required.



STAINLESS

ASSAULT & ROCK 'D'

We created the rockD and Assault stainless to provide the highest quality carabiners to technicians working in harsh environments. The rockD is designed for high strength, and the Assault for versatility.

ANTI-CORROSION



Rock Exotica stainless steel carabiners are the ideal choice for harsh environments. Not only is the frame made from stainless steel, but also the components within the carabiner. Each piece will resist corrosion far beyond the equivalent materials found in other non-stainless carabiners.

ROCK'D' STAINLESS



Auto	Screw
C2S A	C2S S
41kN	41kN
17kN	17kN
11kN	11kN
1.0" (25 mm)	1.0" (25 mm)
4.5" (114 mm)	4.5" (114 mm)
2.5" (64 mm)	2.5" (64 mm)
7.81 oz (221 gm)	7.26 oz (206 gm)
Silver	Silver
CE	CE

**rockD
Stainless**

C2S A (Autolock)
C2S S (Screwlock)

**Assault
Stainless**

C4S A (Autolock)
C4S S (Screwlock)

**rockD
ANSI**
C2S AA

**rockD
LPA
ANSI**
C2S LPAA

Auto ANSI	Auto LPA ANSI	Gate
C2S AA	C2S LPAA	Part#
40kN	40kN	MBS-Major
- kN	- kN	MBS-Minor
14kN	11kN	MBS-Open
16kN	16kN	MBS-Inward
.93" (23.5mm)	.93" (23.5mm)	Gate Opening
4.5" (114 mm)	4.5" (114 mm)	Height
2.7mm (68mm)	2.7mm (68mm)	Width
9.28 oz (263gm)	9.36 oz (265gm)	Weight
Silver	Silver	Color
ANSI Z359.12	ANSI Z359.12	Certification

The rockD ANSI carabiners are ANSI Z359.12 (09) certified.

The rockSteel offers a surprising amount of strength in a lightweight carabiner. It boasts several Rock Exotica features like a keylock, snag-free nose and precise tolerances. Certified for the professional to NFPA "G" and ANSI Z359.

STEEL

ROCKSTEEL

LIGHT & STRONG – ROCKSTEEL

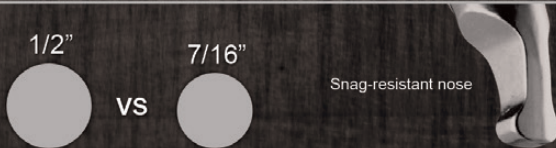

Most steel carabiners are made from 1/2 diameter steel. We use a lighter, 7/16" diameter steel that is heat treated for added strength. Like our aluminum carabiners, the Rocksteel frames are CNC machined for precise fittings and exact tolerances. The result is a carabiner with a high strength-to-weight ratio, keylock snag-resistant nose and a feel like no other carabiner in the world.

ANSI 2009 & NFPA "G" RATED

The rockSteel carabiner is ANSI Z359.12 (09) and NFPA G compliant. The gate/sleeve is rated at 16kN or 3600 lbs, to protect against inward force against gate.

16kN
ANSI GATE



ASSAULT STAINLESS

ROCKSTEEL



Auto
C4S A
30kN
15kN
9kN



Screw
C4S S
30kN
15kN
9kN



Auto
M31 TL
50kN
- kN
18kN
16kN



Screw
M31 SL
45kN
15kN
18kN

1.0" (25 mm)
4.4" (112 mm)
2.75" (70 mm)
7.90 oz (224 gm)
Silver
CE

1.0" (25 mm)
4.4" (112 mm)
2.84" (72 mm)
7.36 oz (209 gm)
Silver
CE

1.2" (30 mm)
4.90" (125 mm)
2.95" (75 mm)
8.80 oz (246 gm)
Silver / Black
CE / ANSI / NFPA

1.2" (30 mm)
4.90" (125 mm)
2.95" (75 mm)
8.10 oz (226 gm)
Silver / Black
CE / NFPA

www.emelwebshop.hu

[illegible]

www.emeloveshop.hu



Twistlock

C2 T

29kN

11kN

9kN

.95" (24 mm)

4.5" (114 mm)

2.7" (68 mm)

2.85 oz (80 gm)

Red

N/A

BiWire

C2 BW

30kN

11kN

9kN

1.1" (28 mm)

4.5" (114 mm)

2.7" (68 mm)

2.40 oz (68 gm)

Red

CE / UIAA

Lanyard Auto

C2 LPA

30kN

11kN

10kN

.96" (24 mm)

4.5" (114 mm)

2.7" (68 mm)

3.52 oz (99 gm)

Bronze / Black

CE / UIAA

Auto

C3 A

24kN

11kN

6kN

.93" (22 mm)

4.4" (111 mm)

2.5" (64 mm)

2.85 oz (80 gm)

Grey / Black

CE / UIAA

ORCA

C3 O

24kN

11kN

6kN

.91" (24.1 mm)

4.4" (111 mm)

2.5" (64 mm)

2.85 oz (80 gm)

Grey / Black

CE / UIAA

Screw

C3 S

24kN

9kN

6kN

.93" (22 mm)

4.4" (111 mm)

2.5" (64 mm)

2.61 oz (73 gm)

Grey / Black

CE / UIAA

Non-Locking

C3 NL

22kN

10kN

6kN

1.0" (25 mm)

4.4" (111 mm)

2.5" (64 mm)

2.36 oz (67 gm)

Grey / Black

CE / UIAA

WireEye Auto

C3 WEA

24kN

9kN

6kN

.93" (22 mm)

4.4" (111 mm)

2.5" (64 mm)

2.96 oz (84 gm)

Grey

CE / UIAA

www.emelwebshop.hu



The unique design of the Omni with a swivel top is equivalent to three pieces of hardware: the pulley, the swivel and the carabiner to connect them. The result is one compact tool that costs less than the three pieces of hardware it replaces.

M A D E I N U S A



www.emelowebshop.hu



The Omni Swivel Pulley is made the same unique way that many of Rock Exotica products are made—from solid material. The design and function of the pulley require a strong core from which the sheaves, side plates, and swivel top must connect. For this we rely on the capability of our state of the art machining centers to take a solid block of

aluminum and cut away material to create this integral part. With precision available only on such a machine, the block of aluminum is transformed into an axle, head piece, becket, and release button housing all in one. The result is a pulley that is lighter, stronger, and more compact than those made by traditional methods and stamped parts.

O M N I - B L O C K

OMNI-BLOCK | SWIVEL PULLEYS

The Omni-Block is made with an integrated swivel and locking sideplate. Unlike traditional pulleys, the Omni is shorter in length and allows for rope changeovers without detaching the pulley. In confined space or high-angle rigging systems, the Omni is the best tool.



FEATURES AND BENEFITS

- Gives you secure access to the pulley without the need to remove it from a carabiner.
- The swivel top allows the pulley to orient as needed in response to the load.
- The patented Omni Block is the only pulley on the market featuring a swivel top and sheaves accessible while still connected to the anchor.
- Pulley body is machined from a solid block of aluminum for strength and weight optimization.
- Shortens the length of rigging by combining the pulley and swivel in one device.
- Pulley utilizes high efficiency ball bearings.



All Omni Block pulleys feature a safety catch that requires the user to push the release button a second time before the sideplate will open.

M A D E I N U S A



O M N I - B L O C K

OMNI-BLOCK

SPECIFICATIONS

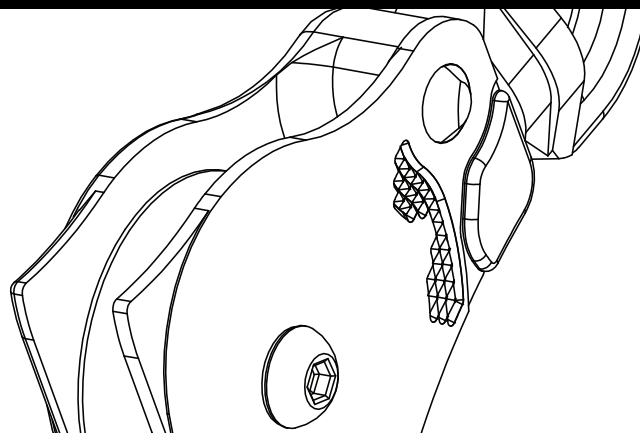

1.5" SINGLE

1.5" DOUBLE

1.1" SINGLE

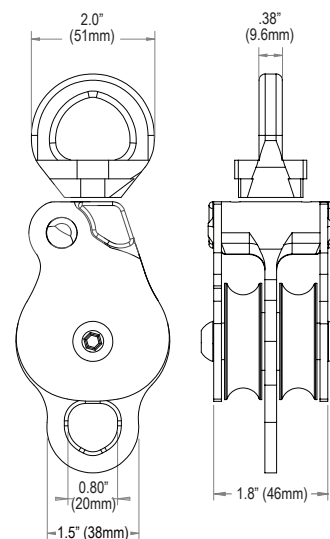
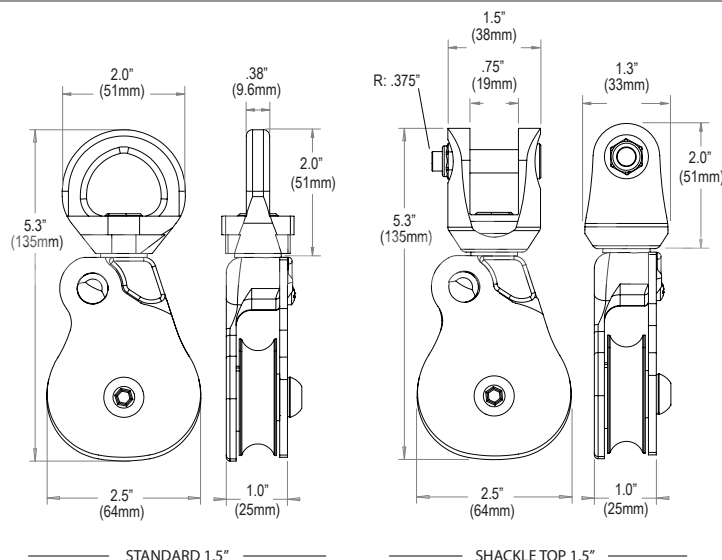
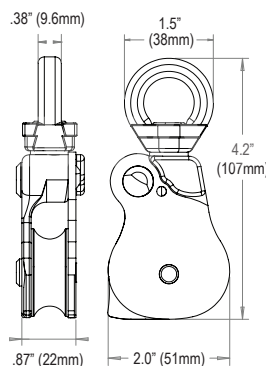

<SPECS

Omni 1.1" (Single)

Part #	P54 / P54-B
Sheave Diameter	1.1" (28mm)
Sheaves	Single
Sheave Material	Aluminum
Available Colors	Standard/Black
Weight	5.1oz (145gm)
MBS	23kN
WLL	5kN
Max Rope	.5" (13mm)
Certification	CE

Omni 1.5" (Single)

Part #	P51 / P51-B
Sheave Diameter	1.5" (38mm)
Sheaves	Single
Sheave Material	Aluminum
Available Colors	Standard/Black
Weight	9.2oz (260gm)
MBS	36kN
WLL	8kN
Max Rope	.5" (13mm)
Certification	CE / UIAA

1.5" (Steel Sheave)

Part #	P51 SS / P51 SS-B
Sheave Diameter	1.5" (38mm)
Sheaves	Single
Sheave Material	Stainless
Available Colors	Standard/Black
Weight	10.7oz (303gm)
MBS	36kN
WLL	8kN
Max Rope	.5" (13mm)
Certification	CE / UIAA

1.5" (Shackle Top)

Part #	P51 SH-B
Sheave Diameter	1.5" (38mm)
Sheaves	Single
Sheave Material	Aluminum
Available Colors	Black
Weight	10.7oz (303gm)
MBS	36kN
WLL	8kN
Max Rope	.5" (13mm)
Certification	N/A

Omni 1.5" (Double)

Part #	P51 D / P51 D-B
Sheave Diameter	1.5" (38mm)
Sheaves	Double
Sheave Material	Aluminum
Available Colors	Standard/Black
Weight	14.5oz (411gm)
MBS	36kN
WLL	8kN
Max Rope	.5" (13mm)
Certification	CE / UIAA

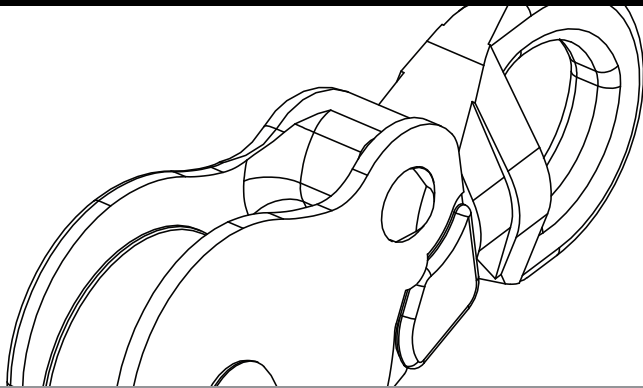

2.0" SINGLE

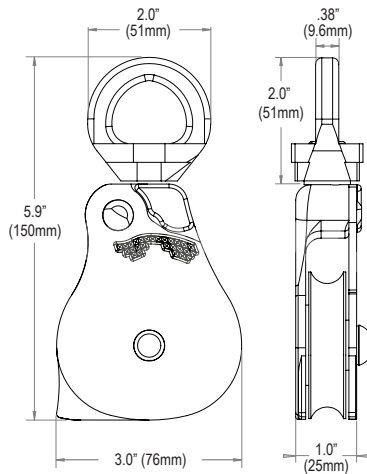

Omni 2.0" (Single)
P53 / P53 D-B
2.0" (51mm)
Single
Aluminum
Standard/Black
12.3oz (348gm)
36kN
8kN
.5" (13mm)
CE / UIAA

2.0" DOUBLE

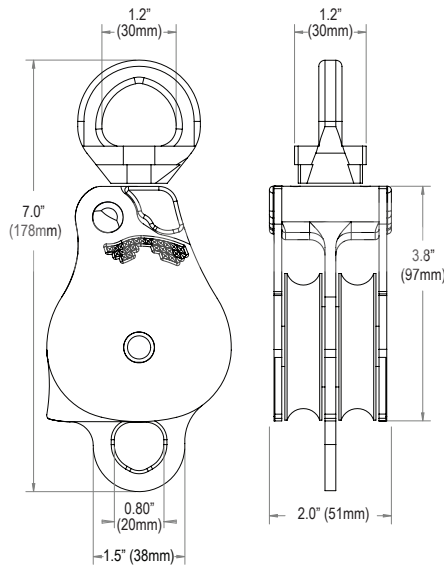

Omni 2.0" (Double)
P53 D / P53 D-B
2.0" (51mm)
Double
Aluminum
Standard/Black
19.4oz (548gm)
40kN
8kN
.5" (13mm)
CE

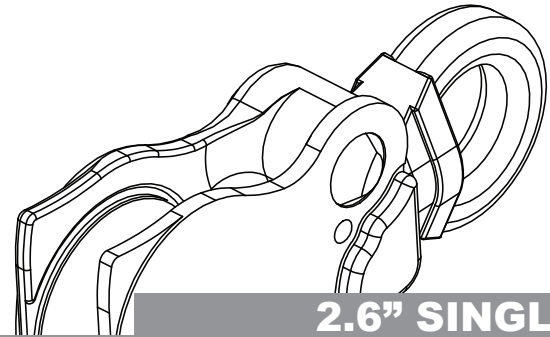

2.6" SINGLE

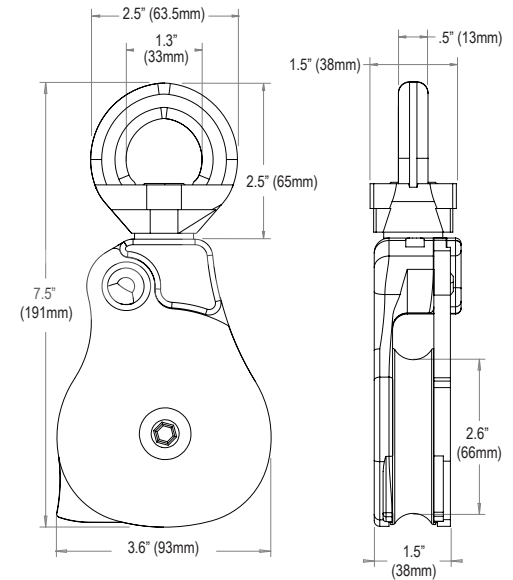

Omni 2.6" (Single)
P55 / P55-B
2.6" (66mm)
Single
Aluminum
Standard/Black
1.9 lbs (850gm)
80kN
20kN
.5" (13mm)
CE

2.6" Rigging Block
MHP55
2.6" (66mm)
Single
Aluminum
Red Plate & Blue Body
1.9 lbs (850gm)
N/A
4,500 lbf
.5" (13mm)
ASME B30

2.6 | OMNI SWIVEL-PULLEY

The new 2.6 Omni Swivel pulley represents a significant size and capacity increase compared to other Omni Pulleys. With a Working Load Limit (WLL) of 20kN, and an overall MBS of 80kN, the 2.6" will stand up to heavy duty use in a variety of industries. The 2.6" Omni is available with modified sheave to accommodate 6mm cord (in black only). Also available is the Omni Rigging-Block, the 2.6" variant rated to ASME B30 rigging standards. See Omni chart for complete specs.

Part Number: P55

Sheave Dia.: 2.6" (66mm)

MBS: 80 kN

WLL: 20kN

Weight: 1.9lbs (850gm)

Max Rope: 0.5" (13mm)

Certification: CE



Part #
MHP55

Max Rope:
0.5" (13mm)

Certification:
ASME B30



Part #
P57

Max Rope:
6mm

Certification:
CE



GEAR & ACCESSORY | TRANSPORTER

The transPorter is designed as a harness "tool-holder" with a special gate for ease of use and security. The gate is equipped with a manual locking mechanism and "wing" design. The manual locking gate is a dual push button design that you can lock to prevent inadvertently snagging or hooking unwanted items. But you can also leave it unlocked when needed so you are able to remove tools quickly without fumbling to unlock the gate. Unique "wings" on the gate allow the user to single-handedly retrieve and sort gear.

The transPorter attaches semi-permanently to the harness, secured by an aluminum plate with removable screws. The wide plate and rigid frame ensure the transPorter will stay in position when used with small or large tools. Machined from solid aerospace-grade aluminum.

Part Number: C5 M
Weight: 2.7oz (76gm)



G E A R F O R T H E Z - A X I S

www.emelowebshop.hu

Photo Credit: Hannes Seiberth, Seiberth Seiltechnik

A R I Z O N A V O R T E X

ARIZONA VORTEX

The Arizona Vortex is the ultimate artificial high directional system (AHD). The Vortex can be set up in multiple configurations including tripod, bi-pod and monopod. Separately the two heads create an a-frame, gin pole, a combination of the two, as well as a multitude of other configurations. The Vortex can be used in a variety of situations including mountain and confined space rescue as well as rope and work access. Many companion products exist to extend the functionality of the Vortex, such as the Omni-block, AZTEK, Kootenay and AZORP, which allow it to meet virtually any requirement for a portable AHD system.

VORTEX | COMPONENTS

The new A-Frame features several changes that will increase the versatility of configurations with the Vortex. The new Vortex Head, as shown on the raw tube to the left, has more pin holes that the legs can be attached with. This allows the

www.emeloveshop.hu

Upper Leg and Push Pin to attach to the Vortex Head in several new positions along the receiving tube. Also, as seen at the bottom, three cutouts have been added to accommodate the index pin on the Lower Leg. This allows the Lower Leg to be reversed and inserted into the A-Frame head with a perfect fit. Both sets of changes increase the degree to which the legs can be adjusted for length and rotation, as well as allowing both sets of legs to connect directly to the A-Frame. The result is the ability to more finely tune the Vortex to the diverse set of positioning requirements encountered in the field.

GIN POLE HEAD (VXGH)

The Gin Pole Head is connected to the A-Frame with the Head Pins to construct the standard Vortex tripod configuration. Many times, the Head is used with a Vortex Leg and Foot to construct a gin pole.

Weight: 2.2 lbs (1 kg)
Length: 8.4" (21.2 cm)
Width: 5" (12.7 cm)
Height: 3" (7.6 cm)

M A D E I N U S A

www.emeloveshop.hu

A-FRAME JOINER (VXAF)

The A-Frame attaches to the Gin Pole Head to construct the standard Vortex tripod configuration. The A-Frame with legs attached on both sides is also used as a standalone, bi-pod rigging piece. The Lower Legs can now be used to connect directly to the A-Frame by inserting the bottom end (stud) of the Lower Leg into the A-Frame. A pulley, Omni-Block, or pulley sheave connects directly to the A-Frame with a quick-release pin to increase the effective height of the Vortex.

Weight: 5.2 lbs (2.3 kg)
Length: 16.4" (41.7 cm)
Width: 3.9" (9.8 cm)
Height: 6.5" (16.5 cm)

Proof Loaded to 23 kN
August 13, 2013

A R I Z O N A V O R T E X

VORTEX | COMPONENTS

RAPTOR FOOT (VXRF)

The Raptor Foot features a replaceable carbide tip designed to reach into small holes or cracks for optimal grip on uneven surfaces. Foot rotation is adjustable to allow correct orientation of claw relative to configuration of Vortex. Two holes and a slot are machined into the Raptor Foot to accommodate hobble straps and other means of anchoring.

Weight:
1 lbs (470 gm)

FLAT FOOT (VXFF)

The Flat Foot features a rubber layer on the bottom to provide optimal grip on flat surfaces. Four anchor points in each corner of the foot, as well as a hole in the leg, allow for a variety of anchoring/hobbling options.

Weight: 3 lbs (1.3 kg)

www.emelowebshop.hu

UPPER LEG (VXUL)

The Upper Leg of the Vortex typically attaches to the A-Frame and fits within the Lower Leg. It can be positioned within the Lower Leg to adjust to different heights as needed. May also be used to attach two Lower Legs and directly to the feet if necessary.

Weight: 4.7 lbs (2.1 kg)
Length: 38.5" (98 cm)
Diameter: 2.0" (5 cm)

LOWER LEG (VXLL)

The Lower Leg of the Vortex attaches to the feet with the permanently attached stud on the bottom (shown on left). This piece may also be reversed and attach to the A-Frame.

Weight: 5.5 lbs (2.5 kg)
Length: 41.5" (105 cm)
Diameter: 2.35" (6 cm)

CAUTION! This is the LAST HOLE >>>

VORTEX | COMPONENTS



HEAD & LEG PUSH PINS

Used for connecting the components of the Vortex, the steel Head and Leg pins are strong, compact and quick to use. Rated at 80kN.

HEAD PIN (VXQR500)

Weight: 2.4 oz (68 gm)
Length: 3.2" (81 mm)
Diameter: .5" (13 mm)

LEG PIN (VXQR375)

Weight: 1.5 oz (43 gm)
Length: 3.9" (98 mm)
Diameter: .37" (9.4 mm)

HEADSET PULLEY WHEEL (VXHPW)

For attachment to the Vortex A-frame using a headpin. 1.5" (38 mm) pulley wheel saves rigging space and is lightweight. Uses high-efficiency bearing.



ARIZONA VORTEX VX2 (BAGS NOT INCLUDED)

HEAD SET VXH & VXAF
PULLEY WHEEL VXPW
HEAD PINS (4) VXQR500
INNER LEGS (3) VXUL
OUTER LEGS (7) VXLL
LEG PINS (11) VXQR375
RAPTOR FEET (3) VXRF
FLAT FEET (3) VXFF

Min Height: 9 ft (2.7 m)
Max Height (with additional legs):
12 ft (3.7 m)
Weight (with both feet sets):
72 lb (33 kg)
MBS: 36kN
Certification: CE

The Vortex and its components are sold exclusively by CMC in the US and Canada.

BAG SET (VXBAGS)

OUTER LEG BAG (3)
INNER LEG BAG
HEAD SET BAG
FOOT BAG
PIN BAG

Made from durable Cordura Nylon, the Vortex Bag set provides a fitted protective cover for a complete Vortex Set and two sets of feet.



ARIZONA OMNI
RIGGING POD

AZORP



The Arizona Omni Rigging Pod (AZORP) is the newest component to the Arizona Vortex AHD. The AZORP extends the rigging options available on the Vortex by providing nine additional connection points with each piece. The AZORP inner and outer pieces (as a set or individually) are designed to fit over either the inner or outer legs of the Vortex. It can be used as the connection point for a Gin Pole, as well as provide a host of other rigging options when used with Vortex Legs on the Vortex, or with Vortex legs as stand-alone rigging pieces.

ARIZONA OMNI RIG POD INNER (VXORP1)
ARIZONA OMNI RIG POD OUTER (VXORP2)
AZORP SET (VXORP SET)



INNER (VXORP1)

Width: 6.5" (16.5 cm)
Height: 4" (10 cm)
Weight: 1.5 lbs (680 gm)
MBS: 36 kN
Includes 1 Pin
Certification: CE



OUTER (VXORP2)

Width: 6.5" (16.5 cm)
Height: 4" (10 cm)
Weight: 1.5 lbs (680 gm)
MBS: 36 kN
Includes 1 Pin
Certification: CE

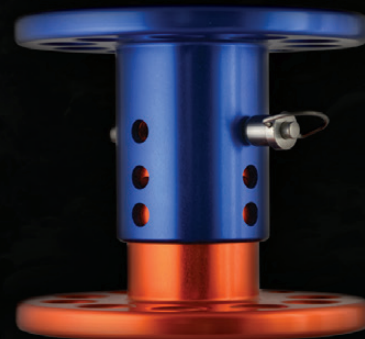

SET (VXORP SET)

Width: 6.5" (16.5 cm)
Min Height: 5.5" (14 cm)
Weight: 3.0 lbs (1.4 kg)
MBS: 36 kN
Includes 2 Pins
Certification: CE

SWIVELS

Rock Exotica made the first high-quality swivels, using stainless steel axles and ball-bearings. Today, our wide range of swivels are used by professionals in a variety of industries all over the world.



NANO (S11)

Weight: 2.0 oz (57 gm)
Breaking Strength: 23 kN
Working load: 3 kN
Certification: CE

This is the lightest load rated swivel on the market. It features an integrated O-ring that holds it snugly in place on most carabiners. Eye .80" (20 mm).



ORBITER (S3)

Weight: 3.5 oz (99 gm)
Breaking Strength: 26 kN
Working load: 5 kN
Certification: CE

The Orbiter swivel is as elegant in its design as it is compact. This low-profile, beveled edge swivel is ideal for special uses where minimum size and weight are required. Eye 1.0" (25 mm).



ROTATOR ROUND (S2 & S2 L)

Weight S2: 3.9 oz (110 gm)
Weight S2 L: 4.5 oz (127 gm)
Breaking Strength: 36 kN
Working load: 5 kN
Certification S2 L: CE

The 1.3" (32mm) eye allows for connection of multiple carabiners. Available in large (S2 L) with large swivel tops on both ends, and small (S2), with a small connection point on one end.



ROTATOR TRIANGLE (S1 L)

Weight: 5.0 oz (143 gm)
MBS: 36 kN
Working load: 5 kN

Rock Thompson had the original idea to create a high-speed triangle swivel. It is still one of the most popular swivels sold today.



SHACKLE SWIVEL (SS1 & SS1 L)

Weight SS1: 6.4 oz (181 gm)
Weight SS1 L: 6.9 oz (195 gm)
MBS: 36 kN
Working load: 5 kN
Certification: Only SS1 CE

The shackle bolt (.375" 9.5mm) is made from stainless steel. This greatly increases longevity when used with cable, steel carabiners or other steel components. The Shackle Swivel comes in two sizes to accommodate standard webbing: a large with a shackle opening width of 1" (SS1 L), and a small with a .75" opening (SS1).



ROTATOR ROUND STAINLESS (S2S & S2S-B)

Weight S2S: 8 oz (227 gm)
Breaking Strength: 36 kN
Working load: 5 kN

This Rotator Round Swivel is made from Stainless Steel to increase durability and longevity. It is best used in harsh environments or connected to other steel components.

SWIVELS | **SWIVA EYE**

The SwivaEye is the integration of our technically advanced carabiners with our high-efficiency, swivels.



SwivaEye
C82 A (Autolock)

MACHINED FRAME

The frame of the SwivaBiner and SwivaEye are machined out of a solid block of aluminum to allow for the complex shape required to attach a swivel at the bottom end. Each frame is milled along the side to remove excess material and weight.

PULL-DOWN GATE

The gate on the Autolock versions use the same ergonomic pull-down and twist mechanism as our other autolocking carabiners.

HIGH-EFFICIENCY BEARING

The SwivaEye uses the same high-efficiency bearings used in our other high quality swivels, ensuring smooth, high-speed rotations.



The SwivaBiner eliminates the need for a separate swivel and two carabiners. Designed for orientation of a load, not for high RPM applications.

SWIVABINER | SWIVELS

MECHANISM: THREE STAGE



Down

1



Twist

2



Open

3

www.emelowebshop.hu



Gate	Auto	Auto
Part#	C82 A	C81 A
MBS-Major	30kN	30kN
MBS-Minor	7kN	7kN
MBS-Open	12kN	12kN
Gate Opening	.84" (21 mm)	.84" (21 mm)
Height	5.4" (137 mm)	7.3" (185 mm)
Width	2.6" (66 mm)	2.6" (66 mm)
Weight	4.8 oz (137 gm)	5.9 oz (166 gm)
Color	Black	Black
Certification	CE	CE

SwivaBiner
C81 A (Autolock)



HIGH STRENGTH BUSHING

The SwivaBiner features a high-strength bushing that will withstand greater abuse than a bearing. The SwivaBiner is designed to re-orient a load, and not provide high-speed rotation.

ENFORCER

Take the guesswork out of your rigging with the lightweight and compact load cell designed for use in training and the real world.

The Enforcer is a compact aluminum load cell that measures force up to 20 kN. Utilizing two sampling modes, the Enforcer is able to monitor systems, and log drop testing in high resolution. Unique features like Bluetooth connectivity and swivel attachment points separate the Enforcer into a class of its own.

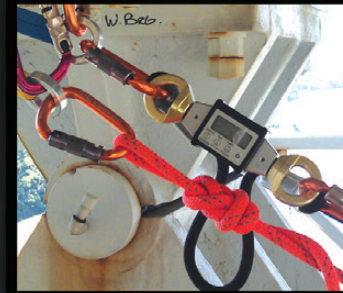

Part #: LC1

MBS: 36 kN

Max Reading: 20 kN

Accuracy: 2%

Length: 8.0" (203mm)

Width: 2.1" (53mm)

Weight: 14 oz (397 gm) w/batteries

Certification: CE

- Lightweight aluminum construction.
- Compact & portable design facilitates "in-line" use in rigging systems.
- Swivel attachment points diminish potentially dangerous torsional and off-axis forces.
- Features two sampling modes: "Slow" for monitoring and "Fast" for drop testing.
- Monitor forces wirelessly on your iPhone with built-in Bluetooth connectivity.
- Record and download graphs of 4-second dynamic events (Enforcer app required. Sold separately)
- Measures force in kg, lbf and kN.

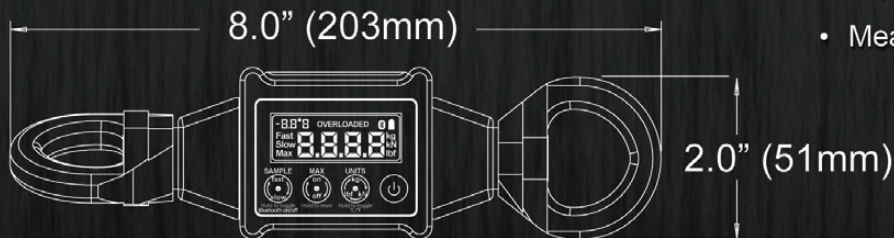

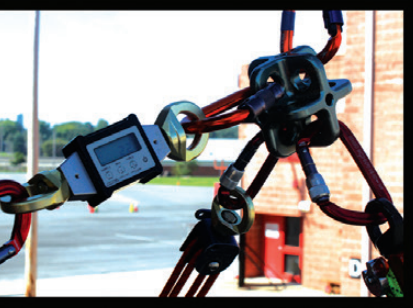

A custom-made case comes with the enForcer.



www.enforwebshop.hu

MONITOR WIRELESSLY VIA BLUETOOTH

The Enforcer iPhone iOS app* lets you monitor forces in your rigging remotely in real-time, and download for later analysis.

*App sold separately
For use with 4S or newer



RIG PLATES

Rock Exotica rig plates are made from oversized material so that all surfaces are machined, even the faces, for flatness, surface defect removal and precise dimensions.



TRIRIG (RP1)

Weight: 1.8 oz (51 gm)
MBS: 36 kN
Height: 2.8" (72 mm)
Width: 3.3" (84 mm)
Certification: CE, NFPA G



PENTA PLATE (RP2)

Weight: 3.8 oz (108 gm)
MBS: 36 kN
Height: 4" (101 mm)
Width: 4.9" (123 mm)
Certification: CE, NFPA G

www.emelowebshop.hu



V5 (RP4)

Weight: 10.9 oz (310gm)
MBS: 36 kN
Height: 5.9" (149mm)
Width: 7.8" (197mm)
Certification: NFPA G

SE7EN (RP3)

Weight: 13.3 oz (376 gm)
MBS: 36 kN
Height: 6" (152 mm)
Width: 9.4" (238 mm)
Certification: CE, NFPA G

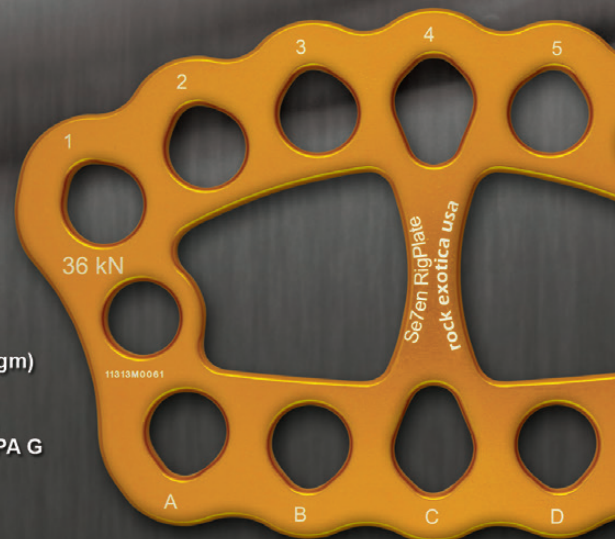

BOLT (RP5)

The BOLT rig plate is made with a quick-detachable stainless steel "bolt." The user can connect gear directly to the five connection points without the use of carabiners. As a result, there is a direct connection to the pulley. This saves space between pulleys and reduces the length of the system.

Weight: 17.3 oz (489gm)
 MBS: 36 kN
 Height: 5" (127mm)
 Width: 8" (203mm)
 Certification: NFPA G



ROCKSTAR | 3D RIGGING

Now professionals have the ability to connect up to seven lines in three dimensions to create a floating anchor. The rockStar relieves the torsional forces that are placed on flat rigplates when connected to lines pulling in opposing axis.

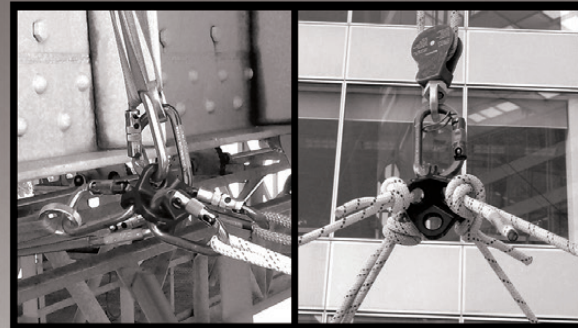

www.emelowebshop.hu



(RP22)
ROCKSTAR

Weight: 7.4 oz (209 gm)
MBS: 36 kN
Width: 3.0" (75 mm)

Height: 3.7" (93 mm)
Depth: 2.6" (65 mm)
Certification: CE, NFPA G

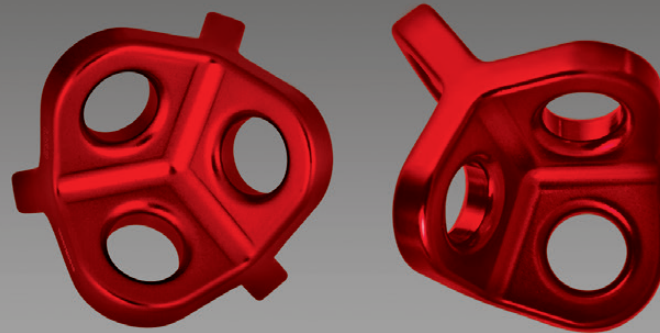

6 MIL DOUBLE PULLEY | DOUBLE-SIX

The Double-Six pulley excels where size and weight are primary factors. With an offset centerplate, the Double-Six can be used as a single pulley without sideloading. Uses sealed ball bearings for maximum efficiency. For rope diameter 6-8mm.

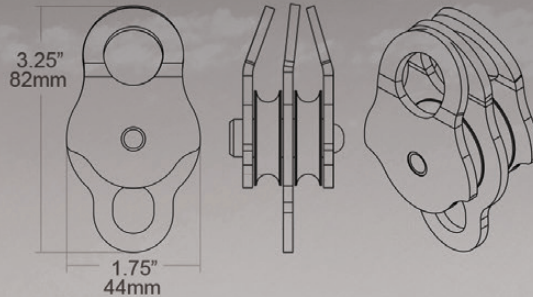

www.emelowebshop.hu



(P6)
DOUBLE-SIX
Weight: 3.3oz (94gm)
MBS: 20kN Single
30kN Double
WLL: 4kN Single
6kN Double
Max Rope: 8.5mm

PULLEYS

Rock Exotica has a long history of producing innovative pulleys. In the late 80's, in collaboration with Arnor Larson, we developed the original knot-passing pulley. Later we developed the Omni-Block, with an integrated swivel and locking sideplate. Today the Mini Machined pulley and Machined Rescue Pulley achieve impressive strength to weight ratios. All of our pulleys reflect Rock Exotica's uncompromising standards for design, materials and processes. The majority of our pulleys feature bearings with integrated axles that create a near frictionless sheave. Rock Exotica still strives to develop the best tools for their users.

MACHINED PULLEYS — WHAT MAKES THEM SPECIAL

- Recessed axle screw sits flush to the pulley sideplates, creating a slim, snag-free profile.
- Axle is integrated into sideplates, adding additional strength and rigidity to the pulley.
- Machined parts create a stronger pulley, increasing its strength to weight ratio.
- Machined sideplates allow for a more compact design while maintaining the same rope capacity of other pulleys.

www.emelowershop.hu

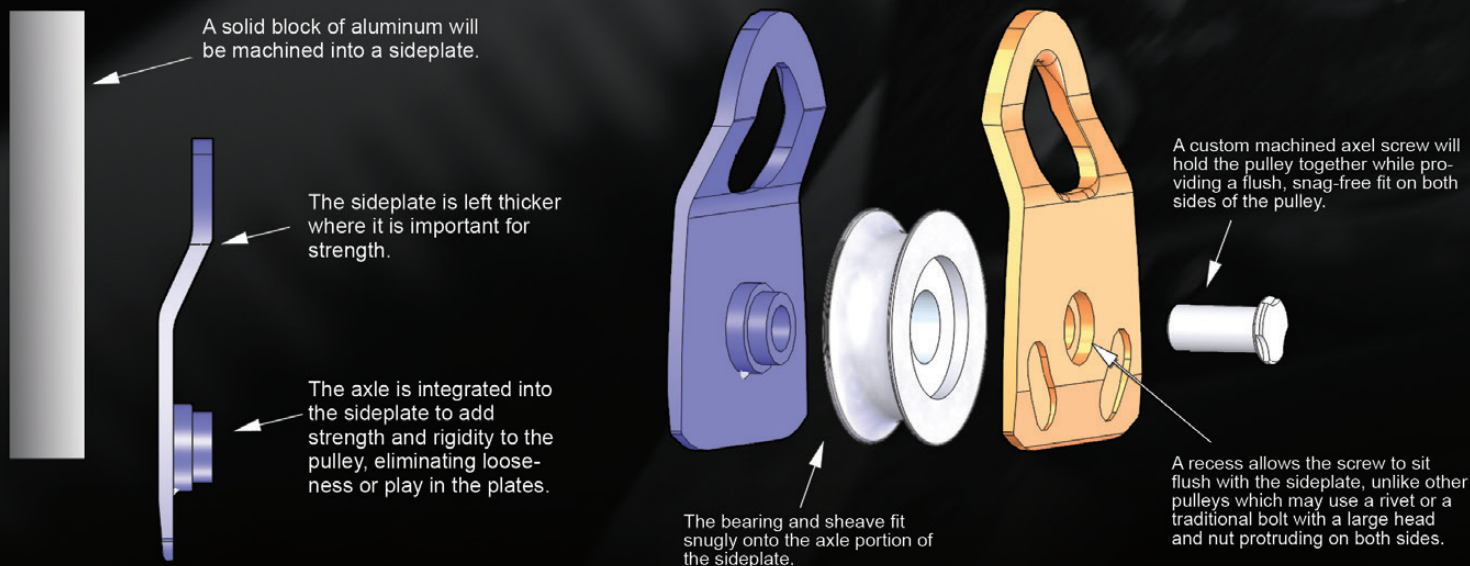

Rock Exotica Machined pulleys are created differently than any other pulley in the world—they are machined from a block of solid aluminum to decrease their size and maximize their strength.

MACHINED PULLEYS

MINI MACHINED SINGLE (P21)

Weight: 2.9 oz (83 gm)
MBS: 2 x 15 kN=30 kN
WLL: 2 x 2.5 kN=5 kN
Max Rope: 11 mm
Sheave Dia: 1.1" (21 mm)
Certification: CE



MINI MACHINED DOUBLE (P21 D)

Weight: 5.0 oz (141 gm)
MBS: 4 x 9 kN=36 kN
WLL: 4 x 2 kN=8 kN
Max Rope: 11 mm
Sheave Dia: 1.1" (21 mm)
Certification: CE



rock exotica

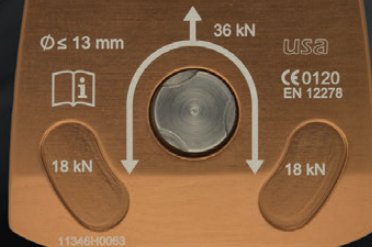

RESCUE SINGLE (P22)

Weight: 5.1 oz (144 gm)
MBS: 2 x 18 kN=36 kN
WLL: 2 x 4 kN=8 kN
Max Rope: 13 mm
Sheave Dia: 1.5" (38 mm)
Certification: CE

rock exotica

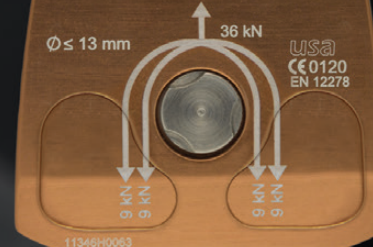

RESCUE DOUBLE (P22 D)

Weight: 9.0 oz (254gm)
MBS: 2 x 18 kN=36 kN
WLL: 4 x 2 kN=8 kN
Max Rope: 13 mm
Sheave Dia: 1.5" (38 mm)
Certification: CE

PULLEYS | PMP

The PMP pulleys are the answer for heavy load situations, with their large 2.0" sheaves and NFPA-G ratings.



PMP SINGLE (P1)

Weight: 11 oz (311 gm)
 Breaking Strength: 2 x 22 kN=44 kN
 Working Load: 2 x 4 kN=8 kN
 Max Rope Diameter: 13 mm
 Sheave Diameter: 2.0" (51 mm)
 Certification: CE, NFPA G



PMP DOUBLE (P1 D)

Weight: 20 oz (575 gm)
 Breaking Strength: 4 x 11 kN=44 kN
 Working Load: 4 x 2 kN=8 kN
 Max Rope Diameter: 13 mm
 Sheave Diameter: 2.0" (51 mm)
 Certification: CE, NFPA G



Photo Credit: Robert Crichton
 TNT Work & Rescue

The original Kootenay knot passing pulley was proposed by the legendary Arnor Larson in the late '80's and made by Rock Exotica. Two holes for tag lines, a dual bearing and other features make the Kootenay Ultra the most advanced pulley of its type.

KOOTENAY | PULLEYS

KOOTENAY ULTRA (P3)

Weight: 25 oz (711 gm)
 Breaking Strength: 2 x 19.5 kN=39 kN
 Working Load: 3 x 3 kN=6 kN
 Max Rope Diameter: 19 mm
 Sheave Diameter: 2.2" (56 mm)
 Certification: CE

- Compact and lightweight, with same capacity of larger Kootenay-style pulleys.
- Locks-off with a single pin, stowable within the axle.
- Dual bearing increases WLL, lifespan and efficiency.
- Two additional holes to separate tag lines and hoist lines, helping prevent spin and limit interference with connectors.



Open
(Bolt Stored)

Screw
Removed

Sheave
Locked



The Kootenay sheave is easily locked off by removing the Lock Screw that is conveniently stored in the axle and threading it into the hole in the sideplate and sheave.



AZTEK SYSTEM

Originally developed in combination with Reed Thorne of Ropes that Rescue, the AZTEK (Arizona Technician's Edge Kit) has become the ultimate personal mechanical advantage system. The AZTEK kit can be configured as a 4:1, 5:1 or 12:1 with the use of an additional pulley. The AZTEK can be used as a pick-off, adjustable redirect, high-directional guyline, attendant tether, litter scoop, load-releasing hitch and much more.

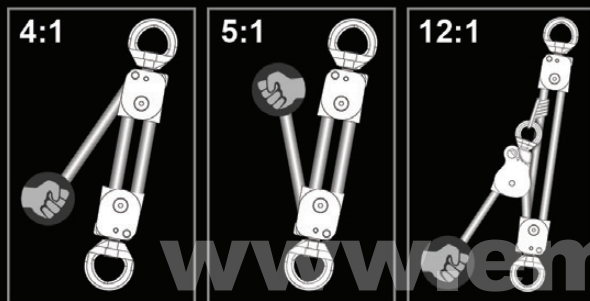

Adding to the overall utility of the AZTEK system, the tail end of the 50' 8mm cord connects to a 44" purcell prusik loop that attaches to the harness, creating an edge restraint. Both the haul system and the edge restraint conveniently deploy from separate pockets from the same compact bag.

COLOR
CODED



EDGE
RESTRAINT



LOW
TENSION
RELEASE



50' CORD
LENGTH



SWIVEL
CONNECTION



AZTEK Kit includes:

- AZTEK PULLEYS
- 6mm PRUSIKS (2)
- 50' 8mm STATIC CORD
- 44" 6mm PURCELL PRUSIK CORD
- PRO OR STANDARD BAG



EDGE
RESTRAINT

MIN LENGTH
9" (22.8cm)



M A D E I N U S A

ADJUSTABLE ATTENDANT TETHER

www.emelowebshop.hu

ADJUSTABLE LITTER SCOOP

SPECS

Kit Weight: 3.4 lbs (1.5kg)
MBS: 36kN
WLL: 3kN Human load
5kN Non-live load
Max Rope: 8 mm
Sheave Diameter: 1.0" (25 mm)

MAX LENGTH
13' (4m)



For more uses of the AZTEK System, including video content, visit www.rockexotica.com/aztek

A Z T E K S Y S T E M

HYDRA | TRIPLE ATTACHMENT PULLEY

Any tool for arborists needs to be lightweight, durable and serve a variety of functions. The HYDRA fits that description by providing the functionality of a pulley with a rigplate. The HYDRA's swivel top offers three connection points lined with rubber o-rings to grip carabiners tightly. These connection points were specifically designed for the rockO carabiner to avoid dangerous cross-loading.

The most simple use of the HYDRA pulley is on the rope bridge of the saddle, but it can be used in a variety of advanced ways. The Hydra is used in ascent systems, lanyard systems, fliplines, or as a redirect as shown below. In any configuration, the use of the HYDRA is greatly enhanced by the flexibility to add multiple connections and rotate when needed.

HYDRA (P4)

Weight:
20 oz (575 gm)
MBS:
2 x 14 kN=28 kN
WLL:
2 x 2.5 kN=5 kN
Max Rope:
13 mm



Our popular rockGrabs feature a smooth cam and choice of an inline or 90 degree connection point.

ROCKGRAB

All versions of the rockGrabs are milled along the side to remove unnecessary material, making it one of the lightest grabs available. Additionally, the axle rests entirely within the body giving the grab a slim profile, free of any protruding bolts or pins. Designed to be left on the rope. The rockGrab 90 models feature a 90° oriented connection point, which excels in use with fliplines and other horizontal lines. Not recommended for vertical ascent.

**(RG4-90)
ROCKGRAB 90°
5/8"**

Weight: 8 oz (227 gm)
Rope Size: 13.5 - 16mm



**(RG2-90)
ROCKGRAB 90°**

Weight: 5 oz (142 gm)
Rope Size: 9-13 mm



**(RG2)
ROCKGRAB**

Weight: 4.6 oz (130 gm)
Rope Size: 9-13 mm

UNICENDER®

Since its inception in 2005, the Unicender has been the most flexible tool for tree climbing. With the ability to be used in both Doubled Rope Technique (DdRT) and Single Rope Technique (SRT), the Unicender fits the way you like to climb like no other tool. The Unicender utilizes unique friction plates that allow it to advance easily with minimal "Sit Back", giving you the most efficiency per

stride. Descending is just as easy: by looping the rope around the plates in SRT as shown below. Additionally, the Unicender attaches conveniently mid-line. For rope sizes 11 to 13mm, or 7/16" to 1/2".



M A D E I N U S A

www.ernestoworkshop.hu

UNICENDER (RG50)

Shown here in Doubled Rope configuration, the Unicender advances easily and efficiently with minimal "Sit Back" on each stride. No transition between gear is necessary with the Unicender; simply compress the plates to smoothly descend. Attaches mid-line.

Weight: 10.9 oz (308 gm)
Rope Size: 11-13 mm

U N I C E N D E R

DESCENDERS



MINI-EIGHT (F1)

Weight: 2.1 oz (60 gm)
 Height: 3.6" (92 mm)
 Width: 3.2" (82 mm)
 Max Rope Dia. (Single Rope): 13 mm
 Max Rope Dia. (Double Rope): 10.5 mm
 Breaking Strength: 14 kN

The MiniEight features side ears that accommodate a wide range of rope sizes, let you easily apply friction, and are easy to tie off. The carabiner hole has a rubber gasket that prevents movement on the carabiner.



RESCUE8 (F3)

Weight: 6.4 oz (181 gm)
 Height: 6" (152 mm)
 Width: 6.25" (158 mm)
 Max Rope (Single Rope): 13mm
 Max Rope (Double Rope): 10.5mm
 Breaking Strength: 22 kN



TOTEM (F10)

The Totem is the 'Swiss Army Knife' of rappelling and rigging devices. Conceived in the canyons of Southern Utah by the widely recognized canyoneering guru Rich Carlson, the Totem reflects the years of his experience in guiding and training in these demanding environments. Deceptively simple-looking, the Totem is remarkably versatile. It's simple to add friction mid-rappel and simple to lock off. Use it for rappelling, ascending, belaying, releasable rigging systems and hauling systems. For more information about the Totem and the many configurations possible, visit the Totem Facebook page at:

www.facebook.com/totem.rigging

Weight: 4.5 oz (128 gm)
 Height: 7.5" (190 mm)
 Width: 2.5" (64 mm)
 Max Rope Diameter (Single Rope): 13
 Max Rope Diameter (Double Rope): 10.5



Photo Credit: Brett Hilbrandt

www.emelowebshop.hu



Rock Exotica LLC
Building E-16
Freeport Center
Clearfield Utah USA 84016
info@rockexotica.com

Photo Credits: Nathanael Ennault (front left), Ryan Stallings (front right), Brandon Nance (rear)